

R3-8a

ADVANCE INTERSECTION LANE CONTROL

*Series 2000 Standard Alphabets.
 **Reduce spacing to fit and optically center.
 ***See page 6-2 for arrow design.

| | A | B | C | D | E | F | G | H | I | J | K | L | M |
|----------|-------|-----|-------|--------|-------|-------|--------|-------|-------|--------|-------|--------|-------|
| C | 48 | 30 | .75 | 1.25 | 4 D | 3 | 12.125 | 1.188 | .438 | 4 | 3.375 | 5.813 | 4.625 |
| | 60 | 36 | .75 | 1.25 | 5 D | 3.5 | 14.875 | 1.188 | .709 | 5.116 | 4.453 | 7.825 | 6.231 |
| | N | O | P | Q | R | S | T | U | V | W | X | Y | Z |
| | 6.625 | 2.5 | 1.688 | 11.063 | 6.813 | 1.688 | 11 | 7.5 | 9.75 | 14.641 | 6.45 | 12.313 | 3 |
| | 8.177 | 3 | 2.408 | 13.617 | 8.812 | 2.125 | 13.2 | 9.5 | 10.96 | 20 | 6.774 | 15.567 | 3 |

COLORS: LEGEND — BLACK
 BACKGROUND — WHITE (RETROREFLECTIVE)

STANDARD ARROW DETAILS

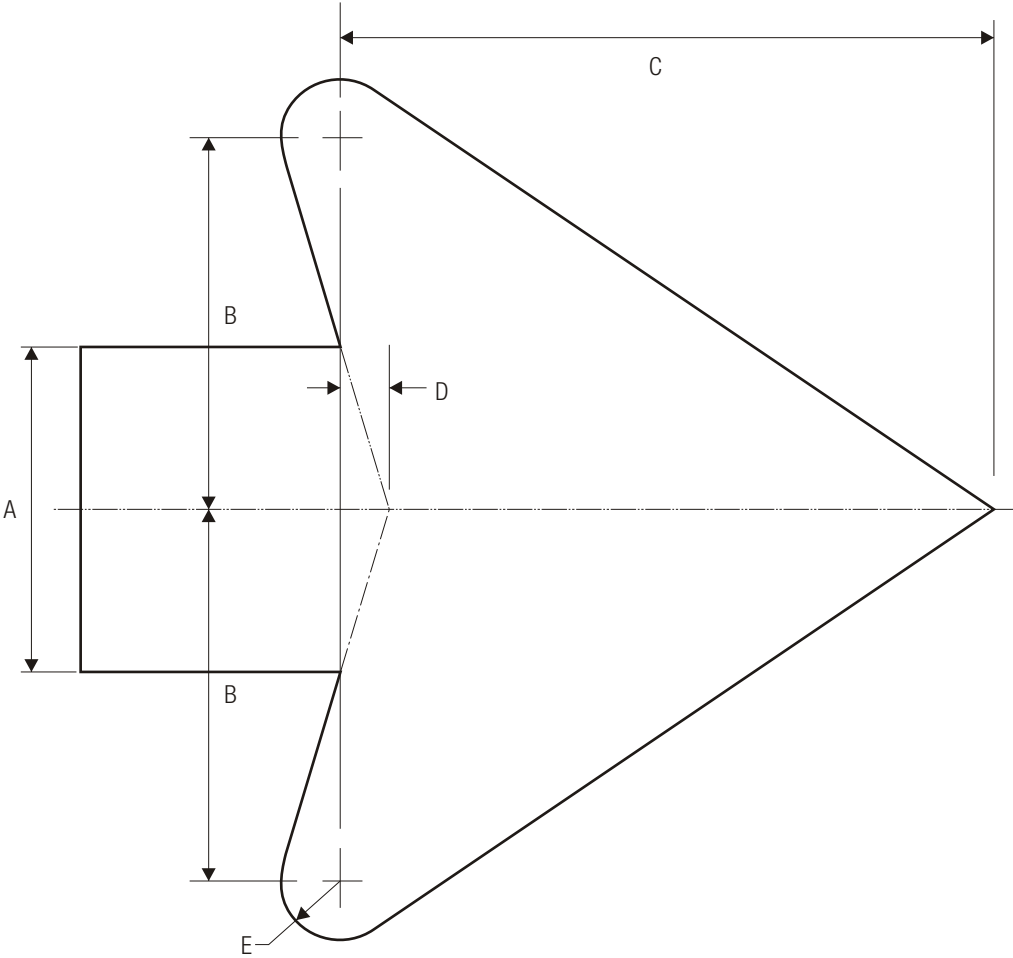

| A | B | C | D | E |
|-------|-------|-------|------|------|
| 2 | 2.313 | 4.313 | .313 | .375 |
| 2.25 | 2.625 | 4.5 | .375 | .438 |
| 2.5 | 2.875 | 5.063 | .375 | .5 |
| 2.625 | 3 | 5.25 | .375 | .5 |
| 2.75 | 3 | 5.563 | .438 | .563 |
| 3 | 3.5 | 6.125 | .438 | .563 |
| 3.125 | 3.625 | 6.375 | .5 | .625 |
| 3.25 | 3.75 | 6.625 | .5 | .625 |
| 3.313 | 3.813 | 6.688 | .5 | .688 |
| 3.5 | 4 | 7.125 | .563 | .688 |
| 3.75 | 4.313 | 7.625 | .563 | .75 |
| 4 | 4.625 | 8.125 | .625 | .813 |
| 4.063 | 4.75 | 8.25 | .625 | .813 |
| 4.25 | 4.875 | 8.625 | .625 | .813 |
| 4.375 | 5 | 8.875 | .688 | .875 |
| 4.5 | 5.188 | 9.125 | .688 | .875 |

| A | B | C | D | E |
|-------|-------|--------|-------|-------|
| 4.75 | 5.438 | 9.625 | .75 | 1 |
| 4.875 | 5.625 | 9.875 | .75 | 1 |
| 5 | 5.75 | 10.125 | .75 | 1 |
| 5.25 | 6 | 10.625 | .813 | 1.063 |
| 5.5 | 6.375 | 11.125 | .875 | 1.125 |
| 5.75 | 6.625 | 11.688 | .875 | 1.125 |
| 6 | 6.875 | 12.188 | .938 | 1.188 |
| 6.5 | 7.5 | 13.188 | 1 | 1.625 |
| 7 | 8 | 14.188 | 1.063 | 1.375 |
| 7.5 | 8.625 | 15.188 | 1.125 | 1.5 |
| 8 | 9.188 | 16.25 | 1.25 | 1.625 |